

***** Position Statement *****

Redistricting Proposal for Tazewell County

In September of 2009, I wrote a column to start the discussions concerning the mandated Redistricting of the Tazewell County Board. This once a decade event is now currently being discussed and the decision needs to be made by our May County Board Meeting. Back in September of 2009 I stated "Now is the time for us to sit down and look at our current districts and ask if we could do better." I believe we have the opportunity today to do just that; to better shape the Tazewell County Board Districts to make sure every county resident's voice is heard.

Currently, we have three political districts with seven members from each district. In 2009, I proposed reducing the size of the districts by moving to seven districts with three members each. Since this initial proposal, I have been pleased with the positive feedback, constructive criticism and suggestions I have received from fellow County Board Members and, most importantly, the general public. We have also now received the 2010 census numbers.

Concerns I have with the current districts include;

- A) While the Rural Townships in Tazewell County have a population totaling more than all but the City of Pekin, the way they are currently divided amongst the three districts none of them total over 31% of any one district. District One has 30% Rural Vote, District Two has 16% Rural Vote and District Three has 31% Rural Vote. The vote power in the County is currently overly focused on the Urban Townships with Pekin having 70% of the vote in District One, Morton having 55% of the vote in District Two and Fondulac and Washington having 69% of the vote in District Three.
- B) The current districts are based on township boundaries. In Tazewell County, many of the municipalities have grown into more than one township. The result is some communities are split as far as County Board Representation. Currently, Tremont is divided almost in half, as is East Peoria, and currently both are divided between District Two and Three. Large parts of Pekin, Marquette Heights, North Pekin and Creve Coeur also are divided between County Board Districts.
- C) Each Tazewell County Board member currently represents over 45,000 citizens. This number is the sixth highest rate in the state while Tazewell County is the 15th highest in population. Lake County, which has a population five times higher than Tazewell County, has a lower representation rate of 30,585. Of our neighboring Counties, Tazewell County's Representation rate is over two and a half times higher than McLean County and is over four times higher than Peoria County. I believe the best form of government is one that is closest to the people they represent. This high representation rate works against that principle in Tazewell County.

Beyond just these concerns I have listed, we need to review this issue and also change the current County Board Districts because of a State Law that mandates that the difference in population between the districts be no higher than 5%. The new 2010 census numbers show us that while all of the districts

saw growth, District Three has grown at a much higher rate than the rest and as such needs to be reduced to meet the State Law.

Based both on the positive feedback I have received and the 2010 census numbers, while my 2009 recommendation is still feasible it could be improved. Also from the feedback I have received, going from three political districts to seven may be too much to do all at once. With the understanding gathered as stated above I have re-reviewed the information and now have three proposals I feel would work better. One proposal calls for Three Political Districts, another calls for Four Political Districts and the last calls for Five Political Districts. All are well within the guidelines of State Law.

Of these three new proposals, I feel my Three District Proposal may be the best fit for Tazewell County at this time. While it does not eliminate all of the concerns I listed above since it will not reduce the high Representation Rate, it does the best job of meeting the rest of my concerns and those concerns I have heard from others.

My new proposals are based more on Municipal Boundaries rather than Township Boundaries. As such, no community is divided in half. For Tremont for example, they currently accounted for 7% of the vote in District Two and 7% of the vote in District Three. Under my proposal they would account for 12% of the vote, second only to the Village of Morton in their new District. In the example of the City of East Peoria, currently they account for 20% of the vote in District Two and 26% of the vote in District Three. Under the new proposal they would account for almost half of the vote in that new district.

My Proposed new District One would be all of the Cities of Pekin, North Pekin, Marquette Heights and Creve Couer including all of Pekin Township and parts of Groveland and Cincinnati Townships. District Three would be the Cities of East Peoria and Washington, including all of Fondulac and Washington Townships and parts of Groveland Township.

The new District Two would be a rural based district, including all of Boynton, Deer Creek, Delavan, Dillon, Elm Grove, Hittle, Hopedale, Little Mackinaw, Mackinaw, Malone, Morton, Sand Prairie, Spring Lake and Tremont and the rural parts of Groveland and Cincinnati Townships. While this new District Two does include the Village of Morton the rural parts of this District would consist of over 60% of the vote, thus a guarantee that the rural voice is represented. Over 45% of the vote in this new District Two would come from south of Route 9.

Even though I favor this new proposed Three District Map, I wanted to present the Four District and Five District Maps for your review. This Redistricting Decision is the largest decision facing us and has long-term ramifications for the future look and make-up of not only the Tazewell County Board but Tazewell County itself. As such, I would appreciate any thoughts and concerns you may have with this issue. As always, I consider it an honor and a privilege to serve you on the Tazewell County Board and if I can be of any assistance to you, please do not hesitate to contact me.

John C. Ackerman
(309) 635-7624
www.JohnCAckerman.com

Three District Proposal * Best Option *

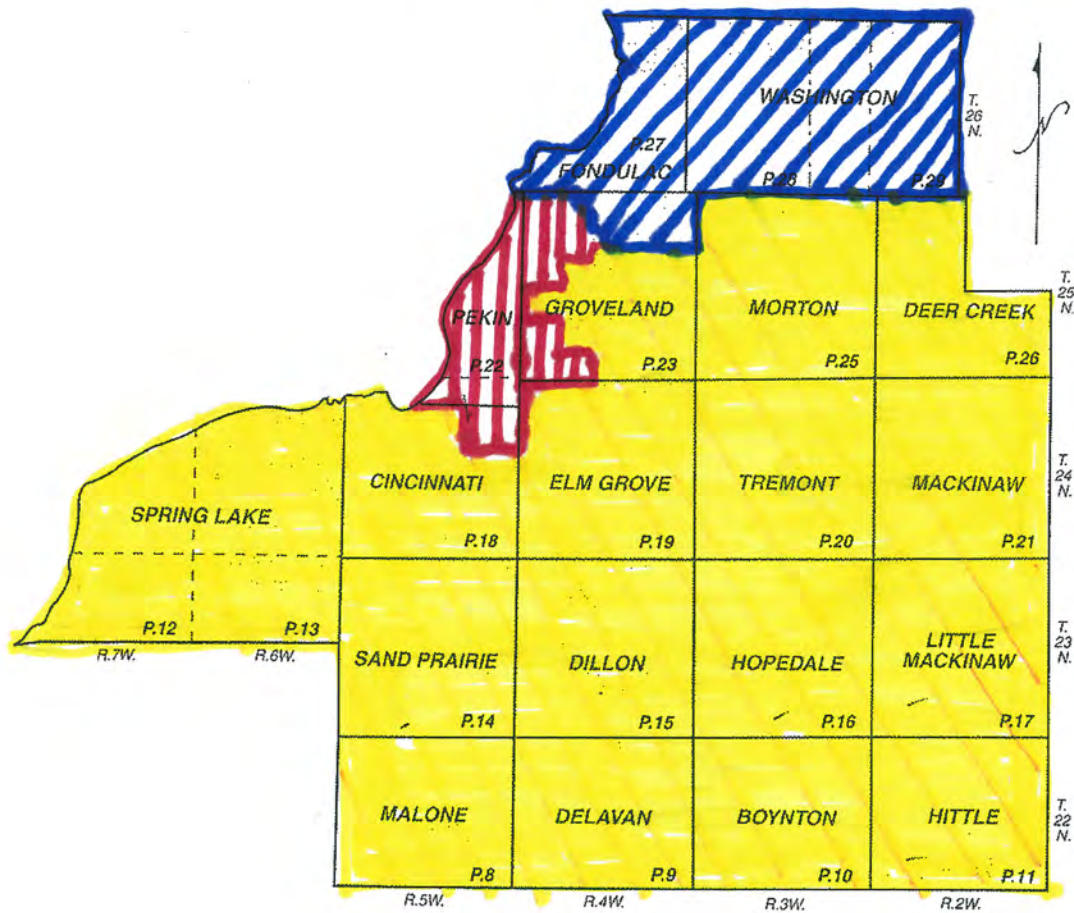

Four District Proposal

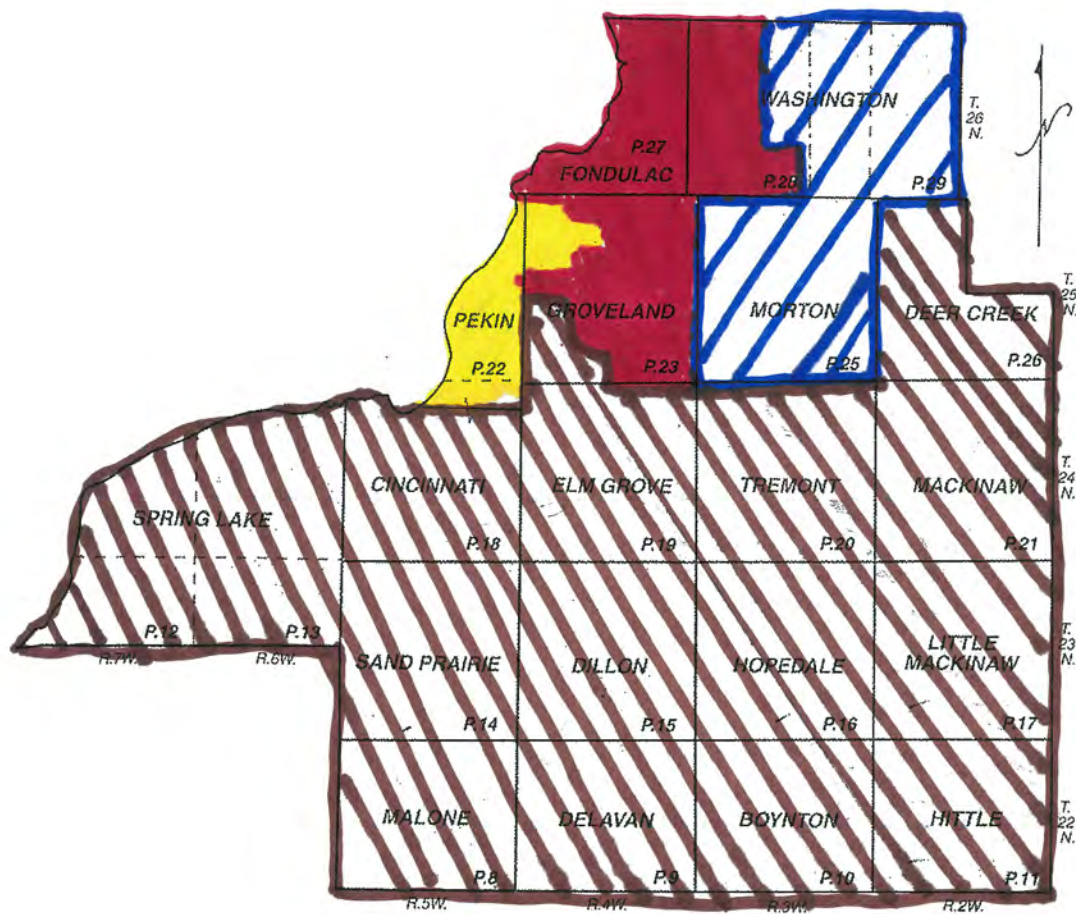

Five District Proposal

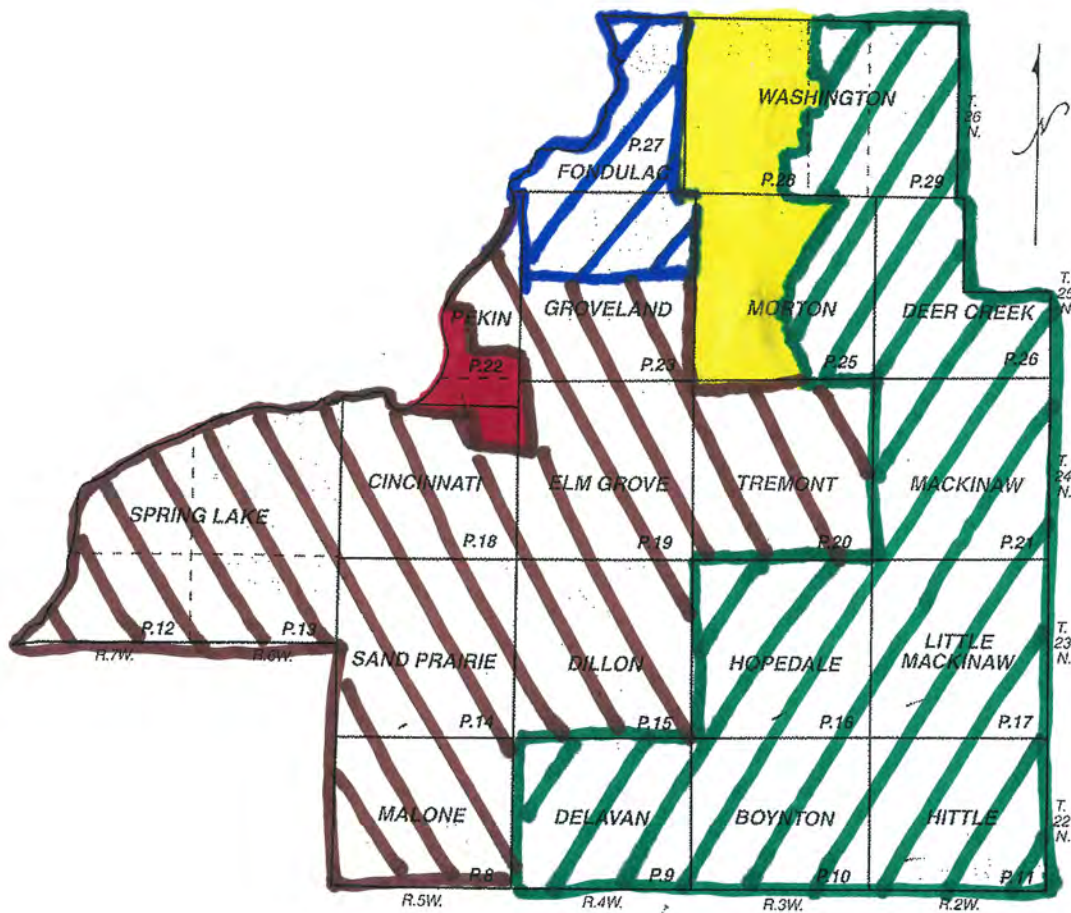

Four District Proposal

District / Township	Population	Total Population	Precinct
District 1			East Peoria, Groveland, Sunnyland, Cloverdale
38% Washington	8970		Washington 5, 6, 8, 12, 13, 14 & 15
Fondulac	13381		
50% Groveland	9763	32114	Groveland 1, 3, 5, 11, 12, 13, 14, 17 & 18
District 2			Morton, Washington
Morton	17036		
62% Washington	14634	31670	Washington 1, 2, 3, 4, 7, 9, 10, 11, 16, 17 & 18
District 3			Pekin, Creve Coeur, Marquette Heights, North Pekin
90% Pekin	26826		Pekin 1, 4, 5, 6, 7, 8, 9, 10, 13, 14, 15, 16, 17, 19, 20, 21, 22, 24, 25, 26, 27, 30, 31, 32, 33, 34 & 35
40% Groveland	7810	34636	Groveland 2, 4, 6, 7, 8, 9, 10 & 16
District 4			Pekin Country Club, Pekin Lake Arlann, Pekin Sunset Hills, Rural Tazewell
10% Pekin	2,981		Pekin 18, 23 & 29
10% Groveland	1,953		Groveland 15 & 19
Boynton	275		
Cincinnati	9506		
Deer Creek	1383		
Delavan	2061		
Dillon	1000		
Elm Grove	3093		
Hittle	591		
Hopedale	1913		
Little Mackinaw	1575		
Mackinaw	4454		
Malone	220		
Sand Prairie	1441		
Spring Lake	1887		
Tremont	2641	36,974	

135,394

Five District Proposal

District / Township	Population	Total Population	Precinct
District 1			City of Pekin
60% Cincinnati	5704		Cincinnati 4, 5, 6 & 7
75% Pekin	22355	28059	Pekin 1, 4, 5, 6, 7, 8, 9, 13, 14, 16, 17, 18, 19, 20, 22, 23, 24, 27, 29, 30, 31, 33 & 34
District 2			Western City of Washington, Village of Morton, Sunnyland
80% Morton	13629		Morton 1, 2, 3, 4, 5, 6, 7, 9, 10, 13, 14 & 16
55% Washington	12982	26611	Washington 5, 6, 8, 10, 12, 13, 14, 15, 16 & 17
District 3			Eastern Washington, Rural Eastern Morton, Deer Creek, Mackinaw, Delavan, Hopedale, Minier
Boynton	275		
Hittle	591		
Hopedale	1913		
Little Mackinaw	1575		
Mackinaw	4454		
Deer Creek	1383		
20% Morton	3407		Morton 8, 11, 12 & 15
45% Washington	10622		Washington 1, 2, 3, 4, 7, 9, 10, 11 & 18
Delavan	2061	26281	
District 4			Cities of East Peoria & Creve Coeur
Fondulac	13381		
70% Groveland	13668	27049	Groveland 2, 3, 4, 5, 6, 7, 8, 9, 11, 12, 13, 14 & 17
District 5			Village of Groveland, Tremont, South Pekin, Pekin Country Club
30% Groveland	5858		Groveland 1, 10, 15, 16, 18 & 19
Elm Grove	3093		
Tremont	2641		
Sand Prairie	1441		
Spring Lake	1887		
Dillon	1000		
25% Pekin	7452		Pekin 10, 15, 21, 25, 26, 32 & 35
Malone	220		
40% Cincinnati	3802	27394	Cincinnati 1, 2 & 3
		135394	